

### Highlights:

- Superior Protection of the 12VDC Power Distribution in any Signal House, Case or Office location
- 20,000 Watts of protection
- LED Protection-Status Indicators
- Reverse Polarity Protection
- Easily mounts on AAR terminal blocks, 1 inch centers
- Small and compact in size
- Strict clamping
- Full 2-Year Warranty
- Operating Temperature -40 to +70°C

### Model SSS-12VDC-20J, DC Indicating Protector

Distributed protection is the most effective form of protection available. Strategic placement of multiple protection units throughout the facility not only provides superior protection but also extends the life of the protection units. **Model SSS-12VDC-20J** provides ample line-to-line circuit protection at a cost effective price.

### Features:

- 20,000 Watts of line-to-line protection will protect through even the harshest transients and surges.
- 50mA bipolar conduction point occurs between 18.90VDC and 20.90VDC. Very strict clamping beyond that point protects equipment from overvoltage.
- LED Protection-Status Indicators show GREEN when fully operational and RED when in need of replacement.
- Units are not damaged by reverse polarity.
- Failed units will NOT load the battery bus.

### Application information:

These devices can be used to protect the main 12VDC House Battery Bus, Individual Rack Power Buses and dedicated signaling apparatus protection. The mounting is simple and quick to standard AAR terminals (1in. centers).

## Model SSS-12VDC-20J

Primary / Secondary / Distributed Battery Protection

**Site-Specific Solutions, Inc**

### Electrical Specifications:

Nominal Input Voltage = 12VDC

Maximum Input Voltage = 17VDC

Energy Handling Capability = 20 Joules

Maximum Peak Current Diverted by the device = 600A

### Dimensions:

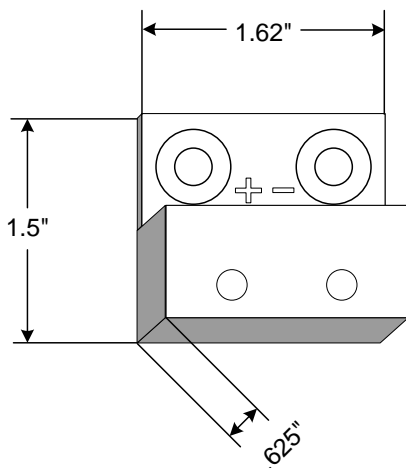

### Functional Diagram:

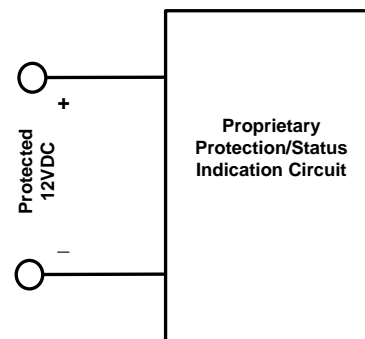

Functional Diagram of the Site-Specific Solutions  
Model SSS-12VDC-20J---12VDC Indicating Protector